

SECOND FLOOR CAPITAL HILTON

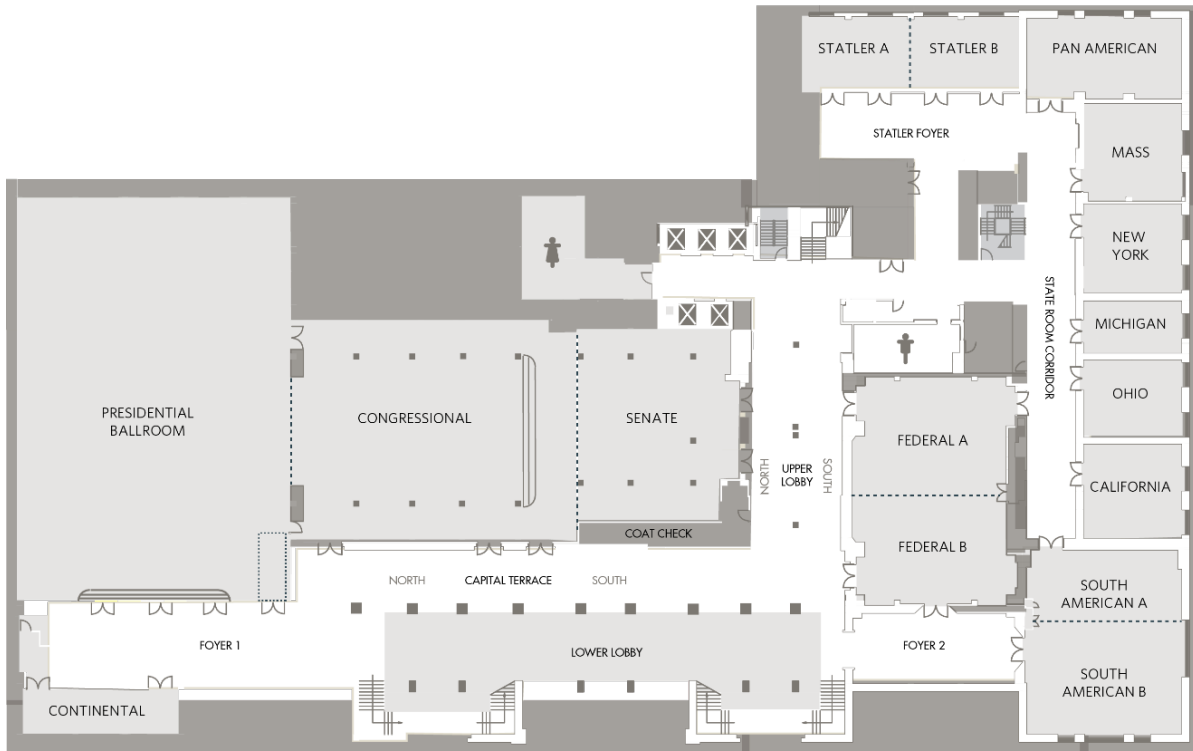

	SQUARE FEET	DIMENSIONS	CEILING HEIGHT	THEATRE	BANQUET ROUNDS OF 10	CRESCENT ROUNDS OF 6	RECEPTION	CLASSROOM 3 PER 6'	CLASSROOM 2 PER 6'	CONFERENCE	HOLLOW SQUARE	U SHAPE	EXHIBITS 8X10	EXHIBITS 10X10	EXHIBITS TABLE TOPS
Presidential Ballroom	7,776	108' x 72'	20'	800	700	420	1000	450	350	-	-	-	28-30	28-30	50-55
Congressional	4,640	80' x 58'	13' 10"	400	300	180	500	200	140	60	80	70	10	9	25
Senate Room	2,236	52' x 43'	10' 5"	150	140	84	150	100	80	30	40	30	6	5-6	16-17
Presidential/Congressional	12,416	-	max: 20' min: 10' 5"	1,200	1,000	600	1500	650	490	-	-	-	42	40	80-82
Congressional/Senate	6,876	-	max: 13' 10" min: 10' 5"	550	440	264	650	300	220	-	-	-	17	14-16	42-45
Presidential/Congressional/Senate	14,652	-	max: 20' min: 10' 5"	1,350	1140	684	1650	750	570	-	-	-	50	45	95-100
Continental Room	516	43' x 12'	11' 2"	40	30	18	50	20	15	30	-	-	-	-	-
Federal AB	2,356	62' x 38'	11' 3"	250	220	132	250	180	140	60	80	70	21	10	30
Federal A	1,178	38' x 31'	11' 3"	125	110	66	125	90	60	30	40	30	-	-	-
Federal B	1,178	38' x 31'	11' 3"	125	110	66	125	90	60	30	40	30	-	-	-
South American AB	2,100	50' x 42'	10' 11"	200	200	120	200	160	130	50	70	50	15	9	23
South American A	798	42' x 19'	10' 11"	75	60	36	60	50	40	40	40	30	-	-	-
South American B	1,302	42' x 31'	10' 11"	125	140	84	125	110	90	40	60	45	-	-	-
California	650	26' x 25'	10' 11"	60	50	30	60	30	25	22	30	26	-	-	-
Ohio	546	26' x 21'	10' 11"	50	50	30	60	30	24	22	30	26	-	-	-
Michigan	364	26' x 14'	10' 11"	-	-	-	-	-	-	14	-	-	-	-	-
New York	624	26' x 24'	10' 11"	60	50	30	60	30	24	22	30	26	-	-	-
Massachusetts	702	27' x 26'	10' 11"	60	50	30	60	30	24	22	30	26	-	-	-
Pan American	861	41' x 21'	10' 11"	70	60	36	75	60	50	40	40	30	-	-	-
Statler AB	1,220	61' x 20'	10'	120	100	60	120	60	50	50	55	45	-	-	-
Statler A	600	30' x 20'	10'	60	50	30	60	30	25	22	30	26	-	-	-
Statler B	620	31' x 20'	10'	60	50	30	60	30	25	22	30	26	-	-	-
Foyer 1	1,188	66' x 18'	10'	-	-	-	-	-	-	-	-	-	-	-	-
Foyer 2	792	44' x 18'	10'	-	-	-	-	-	-	-	-	-	-	-	-
Upper Lobby	1,875	75' x 25'	10'	-	-	-	-	-	-	-	-	-	-	-	10
Capital Terrace	2,100	140 x 15'	10'	-	-	-	-	-	-	-	-	-	-	-	15

* All capacities above are maximum. Please inquire with your manager for audio/visual setups.

NORTH GATE GRILL LOBBY LEVEL

North Gate Grill North	70	existing restaurant table setup with configurations that vary 4-8 seats
North Gate Grill South	60	existing restaurant table setup with configurations that vary 4-8 seats